

BASIC PRODUCT INFORMATION



- Cast iron flue, grate and decor glass as standard.
- Combustion chamber lined with acubet.
- Two flue mounting options - from the top or from the back (when positioned at the back, the main opening is plugged with the heating plate).
- Housing sides available in different colours.
- Possibility of connecting a DGP.
- Independent regulation of primary and secondary air supply, using two levers.
- Modular base - four mounting options (on legs or with a recess for wood).
- Fuel: seasoned hardwood (beech, birch, hornbeam) with moisture content < 20%.

Nominal power [kW]	11
Heating load range [kW]	5,5-14
Thermal efficiency [%]	82
CO emission (at 13% O ₂) [g/m ³]	0,028
Dust emission [g/m ³]	0,921
Average fuel consumption [kg/h]	3,3
Glass dimensions [mm]	880x540
Flue diameter [mm]	150
Inlet diameter [mm]	100
Weight [kg]	190
Efficiency coefficient	109,9



LUPO L

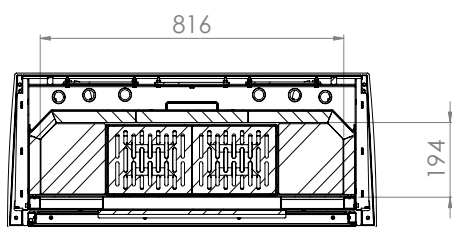
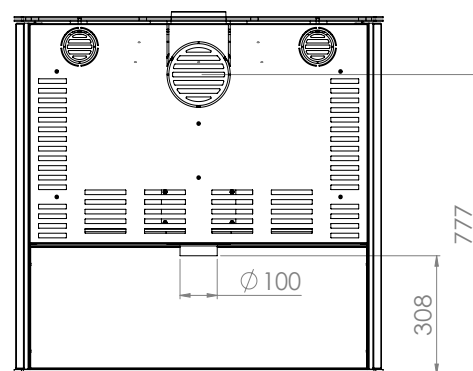
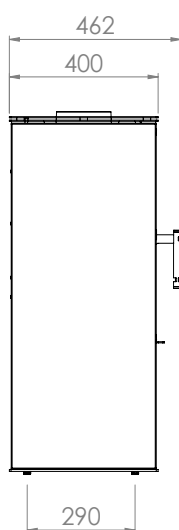
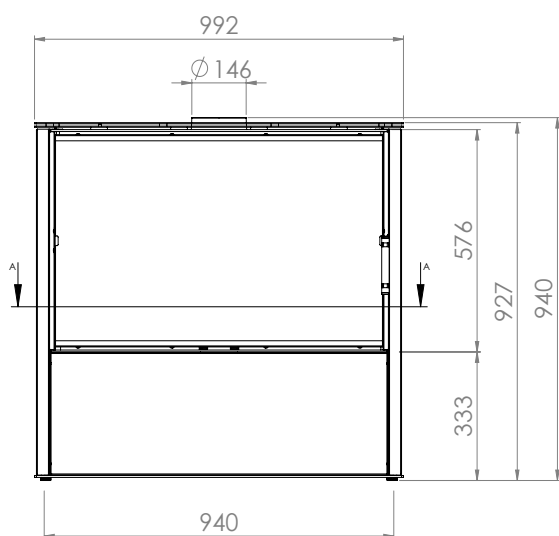

PRZEKRÓJ A-A

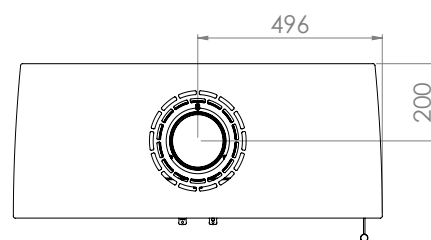

LUPOL

EN/2023/1/LUPO-L/E

DECLARATION OF PERFORMANCE

1. Manufacturer: STALKO SP. Z O.O SP. K., ul. Solec 24/253, 00-403 Warsaw; production: Gdyńska 32, 26-600 Radom
2. Type / identification code: freestanding stove LUPO L 11 kW / LUPO-L
3. Application: space heating in buildings by radiation and convection
4. Name and number of the notified body performing initial type testing: Engineering Testing Institute, s.p. Hudcova 424/56b, 621 00 Brno, Czech Republic,, Jednostka Notyfikowana nr 1015
5. The system or systems of assessment and verification of constancy of performance: system 3
6. Declared performance for a wood-burning freestanding stove:

Basic characteristics	Declared technical parameters
Harmonised technical specification	EN 13240:2001+A2:2004+AC:2006+A2:2004/AC:2006+A2:2004/AC:2007
Fire protection	NPD
Release of hazardous materials	No hazardous substances. No part of the fireplace contains asbestos. No cadmium or any heavy metals are used in the production
Mechanical strength	Exhaust: meets $\varnothing = 147$ mm; L = 53 mm Flue gas ducts: meets ≥ 30 mm
Temperature of surface	Meets
Electrical safety	NPD
Maximum working pressure of water	NPD
Average flue gas temperature	230 °C
Emission CO (13% O ₂)	0,0737 %
Nominal power	11 kW
Nominal power, water	NPD
Energy efficiency	82 %

Performance of the product specified in point 2 are compliant with the declared performance in point 6. This declaration of performance is issued in accordance with REGULATION OF THE EUROPEAN PARLIAMENT AND OF THE COUNCIL (EU) No 305/2011 under the sole responsibility of the manufacturer indicated in point 1.

Radom, 24.01.2023





CEO

Michał Ziomek

STALKO

Spółka z ograniczoną odpowiedzialnością spółka komandytowa
ul. Solec 24/253, 00-403 Warszawa, POLSKA
Biuro: Gdyńska 32, 26-600 Radom, POLSKA
NIP 9482603545, REGON 361379132, KRS 0000836475

 +48 48 380 18 98
+48 800 88 00 30

 info@stalko.com

www.stalko.com