

EN/2023/1/LUPO-M/E

DECLARATION OF PERFORMANCE

1. Manufacturer: STALKO SP. Z O.O SP. K., ul. Solec 24/253, 00-403 Warsaw; production: Gdyńska 32, 26-600 Radom
2. Type / identification code: freestanding stove LUPO M 8,8 kW / LUPO-M
3. Application: space heating in buildings by radiation and convection
4. Name and number of the notified body performing initial type testing: Engineering Testing Institute, s.p. Hudcova 424/56b, 621 00 Brno, Czech Republic,, Jednostka Notyfikowana nr 1015
5. The system or systems of assessment and verification of constancy of performance: system 3
6. Declared performance for a wood-burning freestanding stove:

Basic characteristics	Declared technical parameters
Harmonised technical specification	EN 13240:2001+A2:2004+AC:2006+A2:2004/AC:2006+A2:2004/AC:2007
Fire protection	NPD
Release of hazardous materials	No hazardous substances. No part of the fireplace contains asbestos. No cadmium or any heavy metals are used in the production
Mechanical strength	Exhaust: meets $\varnothing = 147$ mm; L = 53 mm Flue gas ducts: meets ≥ 30 mm
Temperature of surface	Meets
Electrical safety	NPD
Maximum working pressure of water	NPD
Average flue gas temperature	235 °C
Emission CO (13% O ₂)	0,08 %
Nominal power	8,8 kW
Nominal power, water	NPD
Energy efficiency	82 %

Performance of the product specified in point 2 are compliant with the declared performance in point 6. This declaration of performance is issued in accordance with REGULATION OF THE EUROPEAN PARLIAMENT AND OF THE COUNCIL (EU) No 305/2011 under the sole responsibility of the manufacturer indicated in point 1.

Radom, 24.01.2023





CEO

Michał Ziomek

STALKO

Spółka z ograniczoną odpowiedzialnością spółka komandytowa
ul. Solec 24/253, 00-403 Warszawa, POLSKA
Biuro: Gdyńska 32, 26-600 Radom, POLSKA
NIP 9482603545, REGON 361379132, KRS 0000836475

 +48 48 380 18 98
+48 800 88 00 30

 info@stalko.com

www.stalko.com

EN/2024/1/LUPO M/E

DECLARATION OF CONFORMITY

The LUPO M free-standing stove meets the requirements determined by Commission Regulation (EU) 2015/1185 of 24 April 2015 implementing Directive 2009/125/EC of the European Parliament and of the Council with regard to ecodesign for solid fuel local space heaters. The declaration was issued on the base of the test report No. 1015-CPR-30-13266-4 prepared by notified body No. NB1015.

Nominal power	Efficiency	Seasonal energy efficiency	EEI	Energy class
8,7 kW	82 %	72 %	108,9	A+

Emissions*				
Parameter	PM mg/m ³	OGC mg/m ³	CO mg/m ³	NOx mg/m ³
Value	33	72	1001	105
Requirements	≤ 40	≤ 120	≤ 1500	≤ 200

* at 13% O₂

Radom, 24.01.2024

CEO



Michał Ziomek



STALKO

Spółka z ograniczoną odpowiedzialnością spółka komandytowa
ul. Solec 24/253, 00-403 Warszawa, POLSKA
Biuro: Gdyńska 32, 26-600 Radom, POLSKA
NIP 9482603545, REGON 361379132, KRS 0000836475

 +48 48 380 18 98
+48 800 88 00 30 info@stalko.comwww.stalko.com

Characteristics when operated using only recommended fuel								
Parameter	Designation	Value	Unit		Parameter	Designation	Value	Unit
Thermal power					Usable efficiency (calorific value in working condition)			
Nominal thermal power	P _{nom}	8,7	kW		Usable efficiency at nominal thermal power	η _{th, nom}	82	%
Minimum thermal power	P _{min}	-	kW		Usable efficiency at minimum heat output (approximate)	η _{th, min}	-	%
Electricity consumption for own needs					Type of heat output/room temperature control (please select one option)			
At nominal thermal power	e _{l max}	x,xxx	kW		single-stage heat output without room temperature regulation	YES		
With minimal heat output	e _{l min}	x,xxx	kW		at least two manual steps without room temperature control	NO		
In standby mode	e _{l SB}	x,xxx	kW		mechanical regulation of the room temperature using a thermostat	NO		
Energy demand of a constant pilot flame					electronic room temperature control	NO		
Pilot flame energy requirement (if applicable)	P _{pilot}	N/A	kW		electronic room temperature control and 24-hour controller	NO		
					electronic room temperature control and weekly controller	NO		
				Other adjustment options (multiple can be selected)				
				room temperature control with presence detection	NO			
				room temperature regulation with open window detection	NO			
				remote adjustment option	NO			
Contact details	STALKO Spółka z ograniczoną odpowiedzialnością spółka komandytowa ul. Gdyńska 32, 26-600 Radom							

CEO

Michał Ziomek

BASIC INFORMATION ABOUT THE PRODUCT



- Innovative heating plate in the fireplace
- Cast iron flue, grate and decor glass as standard.
- The combustion chamber is lined with acubeth.
- Installation of the flue at the rear (when placed at the rear, the main hole is plugged with a heating plate).
- The sides of the housing are available in different colors.
- Possibility to connect DGP.
- Independent regulation of primary and secondary air supply using two levers.
- Modular base - four mounting options (on legs or with a recess for wood).
- Fuel: seasoned hardwood (beech, birch, hornbeam) with humidity < 20%.
- Heating plate located in the upper part of the body

Nominal power [kW]	8,7
Heating load range [kW]	4-11
Thermal efficiency [%]	82
CO emissions (at 13% O ₂) [g/m ³]	0,033
Pollen emission [g/m ³]	0,480
Average fuel consumption [kg/h]	2,6
Recommended dimensions of outlet grilles	630-720
Recommended dimensions of inlet grilles	360-590
Glass dimensions [mm]	540x540
Flue diameter [mm]	150
Inlet diameter [mm]	100
Weight [kg]	140
Efficiency factor	109,9



LUPO M-CP

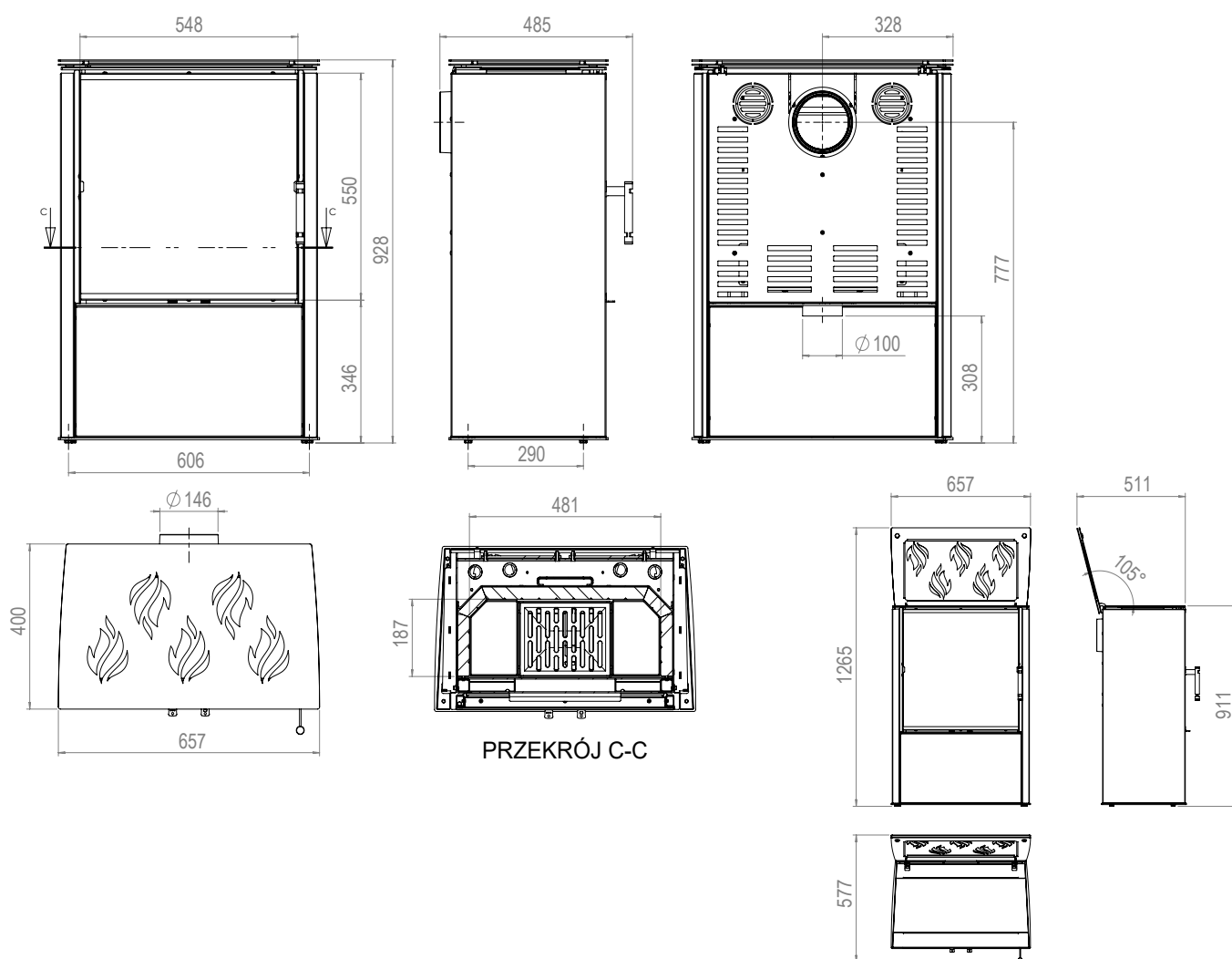

LUPO MCP